

KÄRCHER

makes a difference

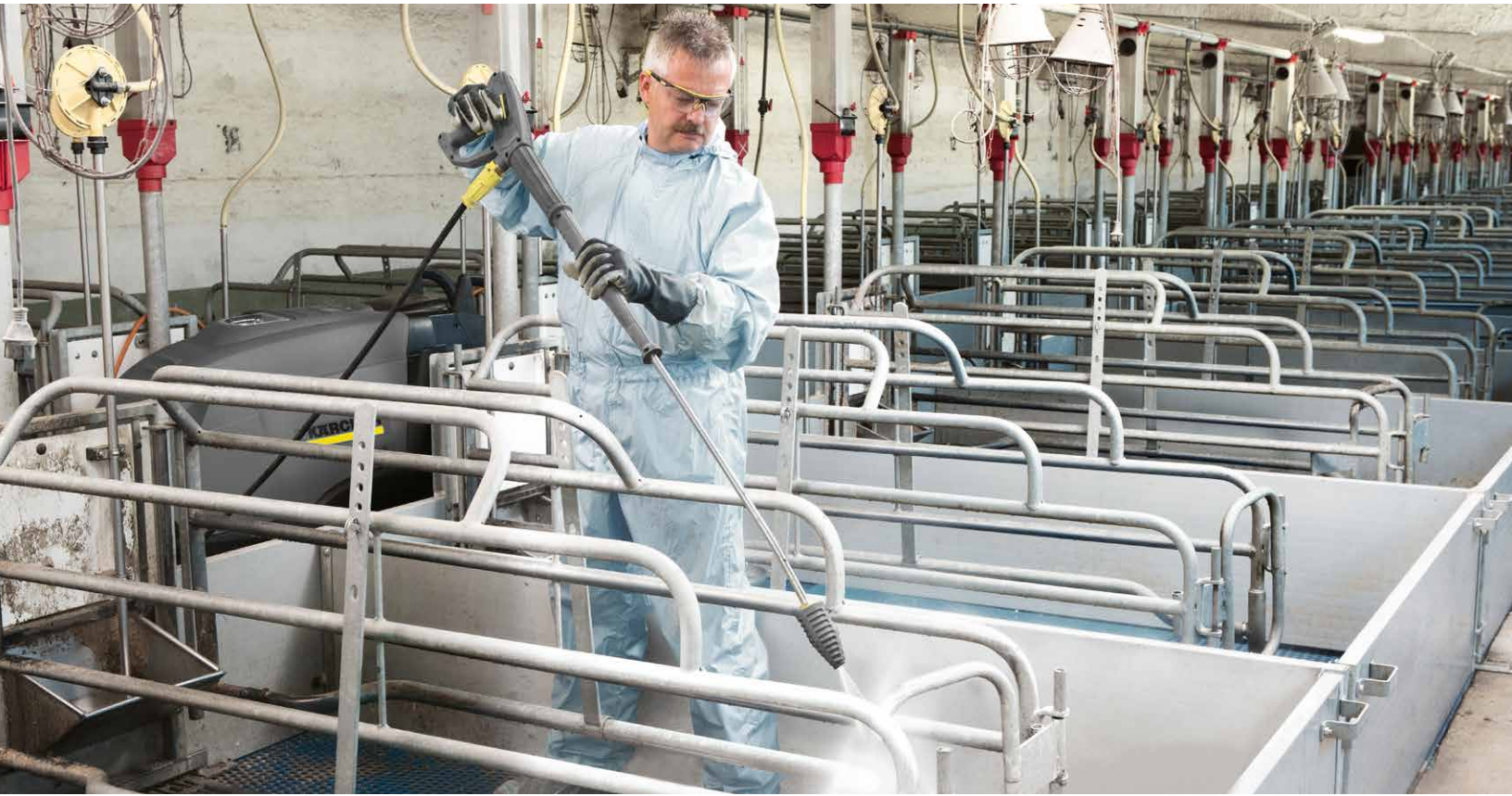

POWERFUL, USER-FRIENDLY AND FUEL-EFFICIENT.

The exceptional cleaners - super and mid class hot water pressure washers.

HDS SUPER AND MID CLASS



Full-size power.

The perfect hot water pressure washer for car dealers, building service contractors, agriculture and municipal use. The mid class machines set the standard in performance, ease of use, economy and service life. Super class hot water pressure washers offer optimum cleaning performance, easy handling and the latest technology.

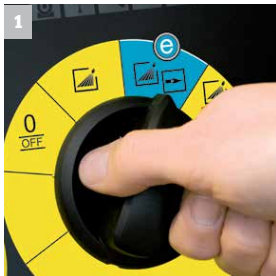

1 Efficiency

- eco:efficiency mode - economical and environmentally friendly, even during longer periods of use.
- Reduces fuel consumption and CO² emissions by 20%.

2 EASY!Force Trigger Gun

- EASY!Force technology holds the trigger down once you start it, avoiding the strain on your hands associated with other trigger guns.

3 Service switch

- Service switch offers a choice of five settings to suit local water hardness. This allows optimum metered quantities of anti-scaler and corrosion inhibitor to be added to the water supply, and prevents the buildup of lime scale on the heater coil. Operating data can be called up at any time, allowing you to make continual adjustments.

4 Time-proven burner technology with new turbo fan

- Kärcher burner technology not only translates to more economical operation, but also makes our hot water pressure washers trendsetters in environmental protection thanks to their low emissions and highly efficient operation.

Technical data and equipment

HDS SUPER CLASS TECHNICAL DATA

Model	Part No.	GPM	PSI	Drive	HP	Electrical	Amps	Pump	Ship Weight (lbs)	Ship Dimensions (L x W x H) Inches
HDS 5.0/30-4S Eb	1.071-919.0	2.4-5.0	460-3000	Direct	11	208-240V / 3ph	27	Kärcher Axial	516	51 x 32 x 45
HDS 5.0/30-4S Ec	1.071-920.0	2.4-5.0	460-3000	Direct	11	460-480V / 3ph	15	Kärcher Axial	516	51 x 32 x 45

HDS SUPER CLASS ACCESSORIES

Order No.	Description
■ 4.118-005.0	EASY!Force trigger gun (German model) - zero force required.
■ 4.112-000.0	41" spray lance
■ 6.110-029.0	50' EASY!Lock Longlife hose with ANTI!Twist connection
■ 2.113-012.0	Power nozzle, 062 (for machine 1.071-908.0)
□ 4.111-041.0	Adapter for EASY!Force trigger gun connecting to 3/8" hose
□ 4.118-009.0	Servo control
□ 8.750-685.0	100' pivot reel
□ 8.921-775.0	Hose reel bracket (complete with Easy!Lock adapter, street elbow and 6' jumper hose)

HDS MID CLASS TECHNICAL DATA

Model	Part No.	GPM	PSI	Drive	HP	Electrical	Amps	Pump	Ship Weight (lbs)	Ship Dimensions (L x W x H) Inches
HDS 4.0/20-4M Ea	1.071-907.0	2.0-4.0	460-2000	Direct	8	220-240V / 1ph	28	Kärcher Axial	495	51 x 32 x 45
HDS 4.5/22-4M Ea	1.071-908.0	2.4-4.5	460-2250	Direct	9.5	220-240V / 1ph	30	Kärcher Axial	501	51 x 32 x 45
HDS 3.5/30-4M Ea	1.071-911.0	2.0-3.5	460-3000	Direct	9.5	220-240V / 1ph	30	Kärcher Axial	500	51 x 32 x 45
HDS 3.5/23-4M Eg	1.071-906.0	2.0-3.5	460-2300	Direct	8.1	200-208V / 1ph	30	Kärcher Axial	500	51 x 32 x 45

HDS MID CLASS ACCESSORIES

Order No.	Description
■ 4.118-005.0	EASY!Force trigger gun (German model) - zero force required.
■ 4.112-000.0	41" spray lance
■ 6.110-029.0	50' EASY!Lock Longlife hose with ANTI!Twist connection
■ 2.113-010.0	Power nozzle, 048 (for machine 1.071-906.0)
■ 2.113-012.0	Power nozzle, 062 (for machine 1.071-908.0)
■ 2.113-021.0	Power nozzle, 040 (for machine 1.071-911.0)
■ 2.113-026.0	Power nozzle, 060 (for machine 1.071-907.0)
□ 4.111-041.0	Adapter for EASY!Force trigger gun connecting to 3/8" hose
□ 4.118-008.0	Servo control
□ 8.750-685.0	100' pivot reel
□ 8.921-775.0	Hose reel bracket (complete with Easy!Lock adapter, street elbow and 6' jumper hose)

Please contact us for
more information:

Kärcher North America

4555 Airport Way
Denver, CO 80239
U.S.A.

Tel. 888-805-9852
Fax 800-248-8409

www.karcher.com/us

Kärcher Canada

275 Pendant Drive
Mississauga, ON L5T 2W9
Canada

Tel. 905-364-5006
Fax 905-672-3155

www.karcher.ca