

ROTARY SURFACE CLEANERS



- driveways, drive-thrus
- patios, garages
- concrete sidewalks
- school yards
- factory & warehouse
- restroom floors
- food processing floors
- service stations
- concrete parking lots
- pool decks
- sport courts
- roofs & decks
- loading docks
- tile flooring
- stadiums
- marina docks
- moss & mildew removal

Hydro Twisters® are industrial flat-surface cleaners that connect to a pressure washer and use a spray bar rotating at a high speed just above the ground to clean concrete more consistently and faster than an operator with a wand, with less fatigue. A surface cleaner uses much less water than a hose wash down. Hydro Twister surface cleaners can be used with cold water or up to 250°F hot water, on some models, for extra stubborn grease or grime, eliminating the need for soap pretreatment in most applications.

The Hydro Twister® Advantage...

- Low Profile Deck: Will fit under benches & machinery
- Less Fatigue: Handle is mounted at an ideal working angle
- Hose is protected inside stainless steel handle (except hoop handles)
- Rustproof, stainless deck / handle and heavy duty for daily use
- Brush guard to reduce splash on building windows and operator



The **TRIDENT HYDRO TWISTERS®** clean more square footage than others in their class. The proprietary aluminum spray arm with compound angled nozzles not only clean up to the edge but also push water aside to create more impact on the surface they clean. All stainless, rustproof deck and handle construction will keep your surface cleaner working and looking great for years.

Trident Hydro Twisters come in two deck sizes, 24" and 28", and your choice of mobility.

Choose the caster version with three non-marking casters that allow the operator to freely move side to side or forward. Handle is free floating and folds flat for storage. The high pressure hose is protected inside the stainless handle tubing, ready for you to connect the pressure washer trigger gun.

If you are looking for a pressure adjustment feature to wash more delicate surfaces or are cleaning large areas, choose the fixed rear wheel option. A front non-marking caster paired with two large, airless tires reduce fatigue when working in straight lines. Dial up or down the pressure as needed from the hoop handle which folds down for carrying or storage.

Models: Choose your deck size and mobility

- 24" deck, 2 nozzles on spray arm, 3 casters
Model# ANT24
- 28" deck, high flow swivel, 4 nozzle spray bar with optimized thrust angle, 3 casters
Model# ANT28
- 24" deck, 2 nozzles on spray arm, two airless rear wheels with hoop handle
Model# ANT25
- 28" deck, high flow swivel, 4 nozzle spray bar with optimized thrust angle, two airless rear wheels with hoop handle
Model# ANT29



The **CONTRACTOR HYDRO TWISTER®** is the proven choice for professional surface cleaning...with four tools for your cleaning needs. The Contractor Twister combines a rotary surface cleaner, spot / gum remover, hydro broom, and an edger to create an all-in-one deluxe surface cleaner. The dual trigger guns activate either the rotary spray arm or one of the other three on-board tools. By combining four processes into one unit, you will save time and fatigue when cleaning large expanses of concrete, parking lots or other flat surfaces. The secret that makes the Contractor Hydro Twister so effective is the ideal water spray angles and nozzle heights that optimize cleaning power. Model# ANT4C

An onboard edging tool cleans close to planters, columns, and walls or use the water broom to rinse a large area

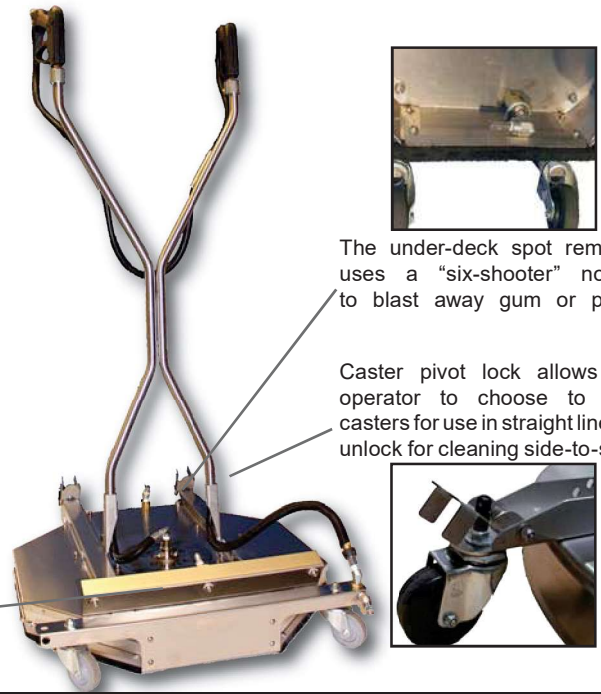

The under-deck spot remover uses a "six-shooter" nozzle to blast away gum or paint.

Caster pivot lock allows the operator to choose to lock casters for use in straight lines or unlock for cleaning side-to-side.



Choose the Hydro Twister with the deck and nozzle size that accommodates your pressure washer					
	ANT24	ANT25	ANT29	ANT28	ANT4C
Max. recommended psi	5000	4000	4000	4000	4000
Max. flow (w/larger nozzle)	6	6	10	10	10
Min. recommendations	3000psi / 3gpm	3000psi / 3gpm	5.5 gpm	5.5 gpm	5.5 gpm
Standard nozzles (15°)	2) #2.7	2) #2.7	2)ea #1 & #2	2)ea #1 & #2	2)ea #1 & #2
Water temperature	cold to 210°F	cold to 210°F	cold to 250°F	cold to 250°F	cold to 250°F
Deck size	24"	24"	28"	28"	28"
Other	High flow, high temperature swivel				
Deck construction	Round stainless deck, brush splash guard			Stainless octagon, brush splash guard	
Handle/frame construction	Stainless, wishbone	Stainless, hoop handle, w/adjustable pressure valve		Stainless, wishbone handle, trigger gun (dual guns on ANT4C)	
Wheel style	3 non-marking casters	1 caster & 2 airless rear tires	3 non-marking casters	4 non-marking casters	

WATER RECOVERY SURFACE CLEANERS



The Twister Vac is a unique rotary surface cleaner with wash water recovery capability. Imagine how efficient you will clean without the hassle of having to do a final rinse or containing wastewater runoff. Using a Twister Vac with your existing hot water mobile wash skid, you will be able to clean flat surfaces up to 20,000 sq. ft. per hour, plus recover your wash water all in one simple step when you connect to a Hydro Vacuum® recovery system.

Stainless construction, 30" deck with brush splash guard. Requires minimum 100cfm/91"lift vacuum source, 2" vacuum hose, and a pressure washer. Suitable for use on greasy factory floors, concrete parking lots and drive-thru areas, gas stations and garages. Model# ANTV5



4000 / 5.5 Max. recommended psi/flow
6 gpm Max. flow (w/larger nozzle)
3000 / 4.8 Min. recommended psi/flow
2) #2.7 nozzles, 15°
cold to 200°F
30" deck (22" cleaning path)
Stainless octagon deck, brush splash guard, floating handle, trigger gun, 4 non-marking casters

For additional Mobile Wastewater Solutions, ask your dealer for the Hydro Vacuum® product line.